



CONEXÕES

ULTRAFLARE



VANTAGENS

Ideais para aplicações em hidráulica e pneumática , como conexão de tubos ou como adaptadores para terminais de mangueiras , possuem uma excepcional resistência mecânica a solda do tubo garantindo perfeitas montagens e desmontagens . Podem ser repetidamente utilizadas com os mesmos resultados de vedação como na montagem inicial .

APLICAÇÕES

Conexões em aço inoxidável recomendadas para tubos de aço inoxidável com ou sem costura , tipo 316 ou 304 com dureza máxima 90HRB conforme ASTM A-269 ou ASTM A-312 ou tubos de aço carbono 1008/1010 para conexões em aço carbono.

Utilizado em geradores , turbinas , instrumentação , máquinas agrícolas , sistemas de lubrificação pressurizada , onde altas temperaturas ou fadiga de material estejam presentes , tais como plataformas , indústrias petroquímicas, naval e de alimentos .

ESPECIFICAÇÕES

As conexões Ultraflare atendem as especificações SAE J514 e J516 .

MATERIAIS

Cotovelos e tees fabricados em aço inoxidável forjado ASTM A-182 GRF316 ou aço carbono ASTM A-576 GR12L14 (SAE 12L14). Conectores , uniões , flange e luva em aço inoxidável ASTM A-276 TP316 ou aço carbono ASTM A-576 GR12L14 (SAE 12L14). O Rings em Buna-N para conexões de aço e Viton para conexões de inox. As conexões em aço carbono são fornecidas bicromatizadas na cor amarela.

INSTRUÇÕES DE MONTAGEM

- 1- Corte o tubo no esquadro e remova as rebarbas ;
- 2- Introduza a flange e a luva no tubo ;
- 3- Expanda a ponta do tubo com ferramenta própria para obter expansão 37° ;
- 4- Monte a boca do tubo já expandido contra a conexão e aperte manualmente. Em seguida , aperte a porca com a chave ,atendendo aos valores de torque* informados abaixo .

TUBO D.E. (pol)	COD.	ROSCA SAE JIC	TORQUE MONTAGEM Nm	TORQUE MONTAGEM lb-ft	PRESSÃO MAX. DE TRABALHO 1* (psi)	PRESSÃO MAX. DE TRABALHO 2* (psi)	ROSCA NPT	PRESSÃO MAX. DE TRABALHO 3* (psi)
1/8"	02	5/16-24	8-9	6-7	5000	5000	1/8	5000
3/16"	03	3/8-24	11-12	8-9	5000	5000	1/8	5000
1/4"	04	7/16-20	15-16	11-12	5000	4500	1/8	5000
5/32"	05	1/2-20	19-21	14-15	5000	4000	1/8	5000
3/8"	06	9/16-18	24-28	18-20	5000	4000	1/4	4000
1/2"	08	3/4-16	49-53	36-39	4500	4000	3/8	3000
5/8"	10	7/8-14	77- 85	57-63	3500	3000	1/2	3000
3/4"	12	1.1/16-12	107-119	79-88	3500	3000	3/4	2500
7/8"	14	1.3/16-12	127-140	094-103	3000	2500	3/4	2500
1"	16	1.5/16-12	147-154	108-113	3000	2500	1	2000
1.1/4"	20	1.5/8-12	172-181	127-133	2500	2000	1-1/4	1150
1.1/2"	24	1.7/8-12	215-226	158-167	2000	1500	1-1/2	1000
2"	32	2.1/2-12	332-350	245-258	1500	1125	2	1000

* Valores para conexões em aço carbono sem lubrificação . Consulte-nos sobre outros materiais

1* Pressão máxima de trabalho para conexões com rosca paralela UNF , uniões e conexões bulkhead.

2* Pressão máxima de trabalho para conexões com porca giratória.

3* Pressão máxima de trabalho para conexões com rosca para cano NPT.

PARA ESPECIFICAR

Os códigos das peças são compostos por números que identificam o tipo , o tamanho da conexão e o material (SS-aço inoxidável ; S-aço carbono bicromatizado).

A primeira série de números e letras identifica o tipo . A segunda descreve o tamanho.

Ex. : 848FSS0804 (Conector macho em inox , 1/2" D.E. x 1/4" NPT).

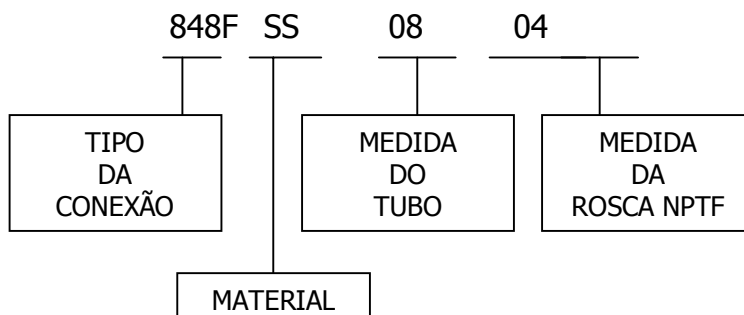

811F
PORCA BULKHEAD
SAE 080118

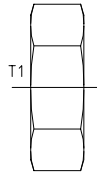

CÓDIGO	T1 UN/UNF	TUBO D.E
811F- -04	7/16-20	1/4
811F- -06	9/16-18	3/8
811F- -08	3/4-16	1/2
811F- -12	1.1/16-12	3/4
811F- -16	1.5/16-12	1

830F
TAMPÃO PARA CONEXÃO
SAE 070112

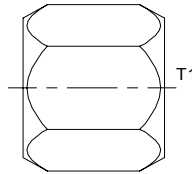

CÓDIGO	T1 UN/UNF	TUBO D.E
830F- -02	5/16-24	1/8
830F- -03	3/8-24	3/16
830F- -04	7/16-20	1/4
830F- -05	1/2-20	5/16
830F- -06	9/16-18	3/8
830F- -08	3/4-16	1/2
830F- -10	7/8-14	5/8
830F- -12	1.1/16-12	3/4
830F- -16	1.5/16-12	1

832F
UNIÃO BULKHEAD
SAE 070601

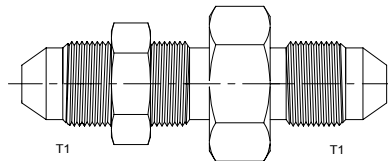

CÓDIGO	T1 UN/UNF	TUBO D.E
832F- -04	7/16-20	1/4
832F- -06	9/16-18	3/8
832F- -08	3/4-16	1/2
832F- -10	7/8-14	5/8
832F- -12	1.1/16-12	3/4
832F- -16	1.5/16-12	1
832F- -20	1.5/8-12	1.1/4



839F
PLUG MACHO
SAE 070109

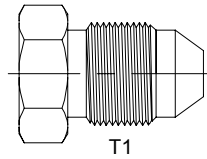

CÓDIGO	T1 UN/UNF	TUBO D.E
839F- -02	5/16-24	1/8
839F- -03	3/8-24	3/16
839F- -04	7/16-20	1/4
839F- -06	9/16-18	3/8
839F- -08	3/4-16	1/2
839F- -10	7/8-14	5/8
839F- -12	1.1/16-12	3/4
839F- -16	1.5/16-12	1

840F
LUVA
SAE 070115

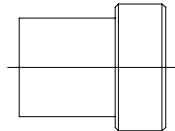

CÓDIGO	TUBO D.E
840F- -02	1/8
840F- -03	3/16
840F- -04	1/4
840F- -05	5/16
840F- -06	3/8
840F- -08	1/2
840F- -10	5/8
840F- -12	3/4
840F- -16	1
840F- -20	1.1/4
840F- -24	1.1/2

841F
FLANGE
SAE 070110

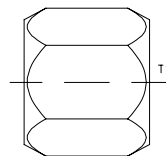

CÓDIGO	T1 UN/UNF	TUBO D.E
841F- -02	5/16-24	1/8
841F- -03	3/8-24	3/16
841F- -04	7/16-20	1/4
841F- -05	1/2-20	5/16
841F- -06	9/16-18	3/8
841F- -08	3/4-16	1/2
841F- -10	7/8-14	5/8
841F- -12	1.1/16-12	3/4
841F- -16	1.5/16-12	1
841F- -20	1.5/8-12	1.1/4
841F- -24	17/8-12	1.1/2

842F
UNIÃO
SAE 070101

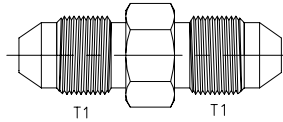

CÓDIGO	T1 UN/UNF	TUBO D.E
842F- -02	5/16-24	1/8
842F- -04	7/16-20	1/4
842F- -05	1/2-20	5/16
842F- -06	9/16-18	3/8
842F- -08	3/4-16	1/2
842F- -10	7/8-14	5/8
842F- -12	1.1/16-12	3/4
842F- -16	1.5/16-12	1

844F
TEE UNIÃO
SAE 070401

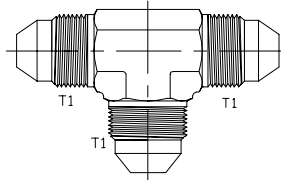

CÓDIGO	T1 UN/UNF	TUBO D.E
844F- -04	7/16-20	1/4
844F- -05	1/2-20	5/16
844F- -06	9/16-18	3/8
844F- -08	3/4-16	1/2
844F- -10	7/8-14	5/8
844F- -12	1.1/16-12	3/4
844F- -16	1.5/16-12	1

845F
TEE MACHO CENTRAL
SAE 070425

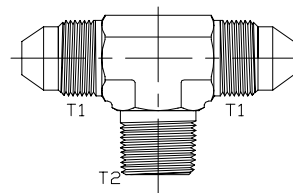

CÓDIGO	T1 UN/UNF	T2 NPT	TUBO D.E
845F- -0402	7/16-20	1/8	1/4
845F- -0404	7/16-20	1/4	1/4
845F- -0502	1/2-20	1/8	5/16
845F- -0604	9/16-18	1/4	3/8
845F- -0606	9/16-18	3/8	3/8
845F- -0608	9/16-18	1/2	3/8
845F- -0806	3/4-16	3/8	1/2
845F- -0808	3/4-16	1/2	1/2
845F- -1008	7/8-14	1/2	5/8
845F- -1212	1.1/16-12	3/4	3/4
845F- -2020	1.5/8-12	1.1/4	1.1/4

845F--O

**TEE MACHO ORIENTÁVEL CENTRAL
SAE 070429**

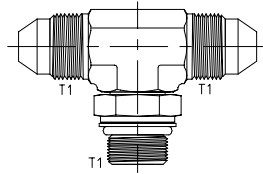

CÓDIGO	T1 UN/UNF	TUBO D.E
845F- -O0404	7/16-20	1/4
845F- -O0606	9/16-18	3/8
845F- -O0808	3/4-16	1/2

846F

**CONECTOR FÊMEA
SAE 070103**

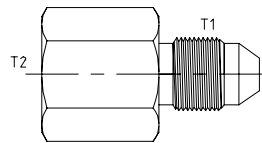

CÓDIGO	T1 UN/UNF	T2 NPT	TUBO D.E
846F- -0202	5/16-24	1/8	1/8
846F- -0402	7/16-20	1/8	1/4
846F- -0404	7/16-20	1/4	1/4
846F- -0604	9/16-18	1/4	3/8
846F- -0606	9/16-18	3/8	3/8
846F- -0608	9/16-18	1/2	3/8
846F- -0806	3/4-16	3/8	1/2
846F- -0808	3/4-16	1/2	1/2
846F- -1008	7/8-14	1/2	5/8
846F- -1212	1.1/16-12	3/4	3/4
846F- -1616	1.5/16-12	1	1

848F
CONECTOR MACHO
SAE 070102

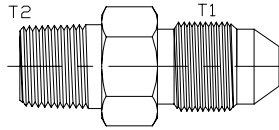

CÓDIGO	T1 UN/UNF	T2 NPT	TUBO D.E
848F- -0202	5/16-24	1/8	1/8
848F- -0302	3/8-24	1/8	3/16
848F- -0402	7/16-20	1/8	1/4
848F- -0404	7/16-20	3/8	1/4
848F- -0406	7/16-20	1/2	1/4
848F- -0408	7/16-20	1/2	1/4
848F- -0502	1/2-20	1/8	5/16
848F- -0504	1/2-20	1/4	5/16
848F- -0602	9/16-18	1/8	3/8
848F- -0604	9/16-18	1/4	3/8
848F- -0606	9/16-18	3/8	3/8
848F- -0608	9/16-18	1/2	3/8
848F- -0804	3/4-16	1/4	1/2
848F- -0806	3/4-16	3/8	1/2
848F- -0808	3/4-16	1/2	1/2
848F- -0812	3/4-16	3/4	1/2
848F- -1008	7/8-14	1/2	5/8
848F- -1204	1.1/16-12	1/4	3/4
848F- -1206	1.1/16-12	3/8	3/4
848F- -1208	1.1/16-12	1/2	3/4
848F- -1212	1.1/16-12	3/4	3/4
848F- -1612	1.5/16-12	3/4	1
848F- -1616	1.5/16-12	1	1
848F- -2020	1.5/8-12	1.1/4	1.1/4
848F- -2024	1.5/8-12	1.1/2	1.1/4

848F--O
CONECTOR MACHO COM O´RING
SAE 070120

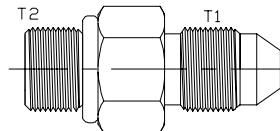

CÓDIGO	T1 UN/UNF	T2 UN/UNF	TUBO D.E
848F- -O0202	5/16-24	5/16-24	1/8
848F- -O0302	3/8-24	5/16-24	3/16
848F- -O0404	7/16-20	7/16-20	1/4
848F- -O0406	7/16-20	9/19-18	1/4
848F- -O0604	9/16-18	7/16-20	3/8
848F- -O0606	9/16-18	9/16-18	3/8
848F- -O0608	9/16-18	3/4-16	3/8
848F- -O0610	9/16-18	7/8-14	3/8
848F- -O0612	9/16-18	1.1/16-12	1/2
848F- -O0804	3/4-16	7/16-20	1/2
848F- -O0806	3/4-16	9/16-18	1/2
848F- -O0808	3/4-16	3/4-16	1/2
848F- -O0810	3/4-16	7/8-14	1/2
848F- -O0812	3/4-16	1.1/16-12	1/2
848F- -O1008	7/8-14	3/4-16	5/8
848F- -O1010	7/8-14	7/8-14	5/8
848F- -O1012	7/8-14	1.1/16-12	5/8
848F- -O1210	1.1/16-12	7/8-14	3/4
848F- -O1212	1.1/16-12	1.1/16-12	3/4
848F- -O1216	1.1/16-12	1.5/16-12	3/4
848F- -O1220	1.1/16-12	1.5/8-12	3/4
848F- -O1610	1.5/16-12	7/8-14	1
848F- -O1612	1.5/16-12	1.1/16-12	1
848F- -O1616	1.5/16-12	1.5/16-12	1
848F- -O1620	1.5/16-12	1.5/8-12	1
848F- -O2016	1.5/8-12	1.5/16-12	1.1/4
848F- -O2020	1.5/8-12	1.5/8-12	1.1/4
848F- -O2024	1.5/8-12	1.7/8-12	1.1/4
848F- -O2424	17/8-12	1.7/8/12	1.1/2

849F
COTOVELO MACHO
SAE 070202

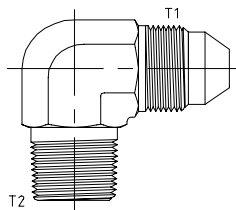

CÓDIGO	T1 UN/UNF	T2 NPT	TUBO D.E
849F- -0302	3/8-24	1/8	3/16
849F- -0402	7/16-20	1/8	1/4
849F- -0404	7/16-20	3/8	1/4
849F- -0406	7/16-20	1/2	1/4
849F- -0408	7/16-20	1/2	1/4
849F- -0504	1/2-20	1/4	5/16
849F- -0506	1/2-20	3/8	5/16
849F- -0602	9/16-18	1/8	3/8
849F- -0604	9/16-18	1/4	3/8
849F- -0606	9/16-18	3/8	3/8
849F- -0608	9/16-18	1/2	3/8
849F- -0804	3/4-16	1/4	1/2
849F- -0806	3/4-16	3/8	1/2
849F- -0808	3/4-16	1/2	1/2
849F- -0812	3/4-16	3/4	1/2
849F- -1006	7/8-14	3/8	5/8
849F- -1008	7/8-14	1/2	5/8
849F- -1206	1.1/16-12	3/8	3/4
849F- -1208	1.1/16-12	1/2	3/4
849F- -1212	1.1/16-12	3/4	3/4
849F- -1612	1.5/16-12	3/4	1
849F- -1616	1.5/16-12	1	1
849F- -1620	1.5/16-12	1.1/4	1
849F- -2424	17/8-12	1.1/2	1.1/2

849F--O
COTOVELO MACHO ORIENTÁVEL
SAE 070220

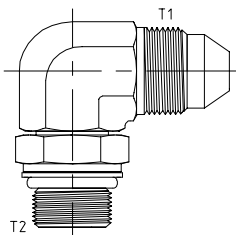

CÓDIGO	T1 UN/UNF	T2 UN/UNF	TUBO D.E
849F- -O0404	7/16-20	7/16-20	1/4
849F- -O0604	9/16-18	7/16-20	3/8
849F- -O0606	9/16-18	9/16-18	3/8
849F- -O0608	9/16-18	3/4-16	3/8
849F- -O0804	3/4-16	7/16-20	1/2
849F- -O0806	3/4-16	9/16-18	1/2
849F- -O0808	3/4-16	3/4-16	1/2
849F- -O0812	3/4-16	1.1/16-12	1/2
849F- -O1010	7/8-14	7/8-14	5/8
849F- -O1212	1.1/16-12	1.1/16-12	3/4
849F- -O1216	1.1/16-12	1.5/16-12	3/4
849F- -O1612	1.5/16-12	1.1/16-12	1
849F- -O1616	1.5/16-12	1.5/16-12	1
849F- -O2020	1.5/8-12	1.5/8-12	1.1/4



850F
COTOVELO FÊMEA
SAE 070203

CÓDIGO	T1 UN/UNF	T2 NPT	TUBO D.E
850F- -0402	7/16-20	1/8	1/4
850F- -0404	7/16-20	1/4	1/4
850F- -0604	9/16-18	1/4	3/8
850F- -0606	9/16-18	3/8	3/8
850F- -0806	3/4-16	3/8	1/2
850F- -0808	3/4-16	1/2	1/2
850F- -1212	1.1/16-12	3/4	3/4
850F- -1616	1.5/16-12	1	1

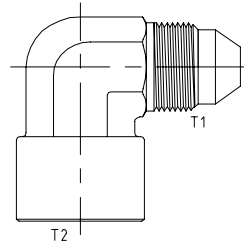

851F
TEE MACHO LATERAL
SAE 070424

CÓDIGO	T1 UN/UNF	T2 NPT	TUBO D.E
851F- -0402	7/16-20	1/8	1/4
851F- -0404	7/16-20	1/4	1/4
851F- -0604	9/16-18	1/4	3/8
851F- -0606	9/16-18	3/8	3/8
851F- -0806	3/4-16	3/8	1/2

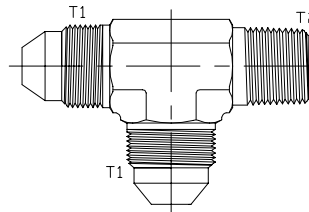

851F--O
TEE MACHO ORIENTÁVEL LATERAL
SAE 070428

CÓDIGO	T1 UN/UNF	T2 UN/UNF	TUBO D.E
851F- -O0606	9/16-18	9/16-18	3/8

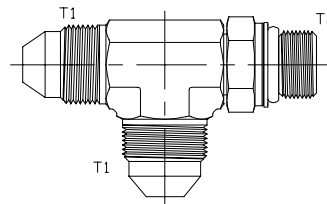

852F
CRUZETA
SAE 070501

CÓDIGO	T1 UN/UNF	TUBO D.E
852F- -04	7/16-20	1/4
852F- -06	9/16-18	3/8
852F- -08	3/4-16	1/2

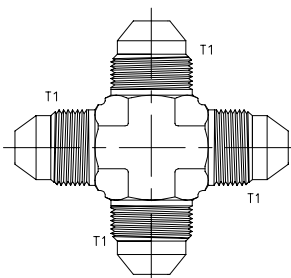

854F
COTOVELO MACHO 45°
SAE 070302

CÓDIGO	T1 UN/UNF	T2 NPT	TUBO D.E
854F- -0402	7/16-20	1/8	1/4
854F- -0404	7/16-20	1/4	1/4
854F- -0406	7/16-20	3/8	1/4
854F- -0408	7/16-20	1/2	1/4
854F- -0504	1/2-20	1/4	5/16
854F- -0604	9/16-18	1/4	3/8
854F- -0606	9/16-18	3/8	3/8
854F- -0806	3/4-16	3/8	1/2
854F- -0808	3/4-16	1/2	1/2
854F- -1212	1.1/16-12	3/4	3/4
854F- -1616	1.5/16-12	1	1

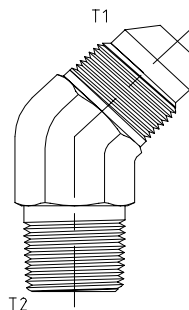

854BHF
COTOVELO 45° BULKHEAD
SAE 070801

CÓDIGO	T1 UN/UNF	TUBO D.E
854BHF- -06	9/16-18	3/8
854BHF- -08	3/4-16	1/2
854BHF- -10	7/8-14	5/8

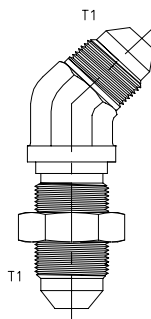

854F--O
COTOVELO 45° ORIENTÁVEL
SAE 070320

CÓDIGO	T1 UN/UNF	T2 UN/UNF	TUBO D.E
854F- -O0606	9/16-18	9/16-18	3/8
854F- -O0808	3/4-16	3/4-16	1/2
854F- -O1010	7/8-14	1.1/16-12	5/8
854F- -O1212	1.1/16-12	1.1/16-12	3/4
854F- -O1616	1.5/16-12	1.5/16-12	1
854F- -O2020	1.5/8-12	1.5/8-12	1.1/4

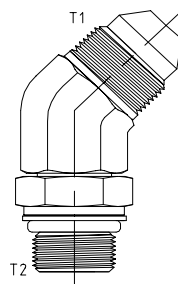

855F
COTOVELO UNIÃO
SAE 070201

CÓDIGO	T1 UN/UNF	TUBO D.E
855F- -04	7/16-20	1/4
855F- -06	9/16-18	3/8
855F- -08	3/4-16	1/2
855F- -10	7/8-14	5/8
855F- -12	1.1/16-12	3/4
855F- -16	1.5/16-12	1.1/4

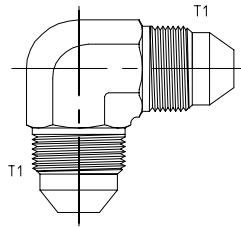

855BHF
COTOVELO 90° BULKHEAD
SAE 070701

CÓDIGO	T1 UN/UNF	TUBO D.E
855BHF- -04	7/16-20	1/4
855BHF- -06	9/16-18	3/8
855BHF- -08	3/4-16	1/2
855BHF- -10	7/8-14	5/8
855BHF- -12	1.1/16-12	3/4
855BHF- -16	1.5/16-12	1.1/4
855BHF- -20	1.5/8-12	1.1/4
855BHF- -24	17/8-12	1.1/2

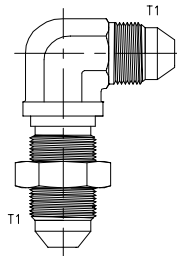

870F
TEE BULKHEAD CENTRAL
SAE 070959

CÓDIGO	T1 UN/UNF	TUBO D.E
870F- -06	9/16-18	3/8
870F- -08	3/4-16	1/2
870F- -12	1.1/16-12	3/4

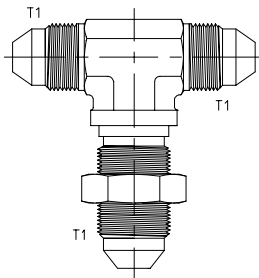

871F
TEE SWIVEL LATERAL
SAE 070432

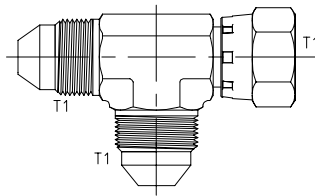

CÓDIGO	T1 UN/UNF	TUBO D.E
871F- -04	7/16-20	1/4
871F- -06	9/16-18	3/8
871F- -08	3/4-16	1/2
871F- -12	1.1/16-12	3/4
871F- -16	1.5/16-12	1.1/4
871F- -20	1.5/8-12	1.1/4

872F
TEE SWIVEL CENTRAL
SAE 070433

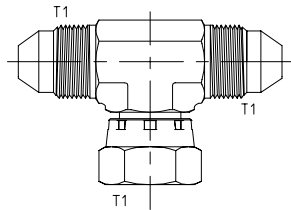

CÓDIGO	T1 UN/UNF	TUBO D.E
872F- -06	9/16-18	3/8

879F
COTOVELO SWIVEL
SAE 070221

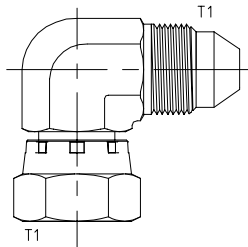

CÓDIGO	T1 UN/UNF	TUBO D.E
879F- -04	7/16-20	1/4
879F- -06	9/16-18	3/8
879F- -08	3/4-16	1/2
879F- -10	7/8-14	5/8
879F- -12	1.1/16-12	3/4
879F- -16	1.5/16-12	1
879F- -20	1.5/8-12	1.1/4

883FSS
REDUTOR
AÇO INOXIDÁVEL

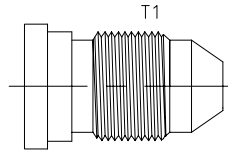

CÓDIGO	T1 UN/UNF	TUBO D.E
883FSS0402	5/16-24	1/4
883FSS0604	7/16-20	3/8
883FSS0804	7/16-20	1/2
883FSS0806	9/16-18	1/2
883FSS1004	7/16-20	5/8
883FSS1006	9/16-18	5/8
883FSS1008	3/4-16	5/8
883FSS1204	7/16-20	3/4
883FSS1206	9/16-18	3/4
883FSS1208	3/4-16	3/4
883FSS1612	1.1/16-12	1

SAE 070123
TIPO A
REQUER FLANGE 841F

883F
REDUTOR
AÇO CARBONO

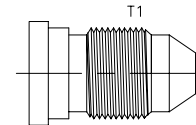

CÓDIGO	T1 UN/UNF	T2 UN/UNF	TUBO D.E
883FS0402-B	7/16-20	5/16-24	1/4
883FS0604-B	9/16-18	7/16-20	3/8
883FS0804-A	7/16-20	--	1/2
883FS0804-B	3/4-16	7/16-20	1/2
883FS0806-B	3/4-16	9/16-18	1/2
883FS1008-B	7/8-14	3/4-16	5/8
883FS1206-A	9/16-18	--	3/4
883FS1208-A	3/4-16	--	3/4
883FS1208-B	1.1/16-12	3/4-16	3/4
883FS1210-B	1.1/16-12	7/8-14	3/4
883FS1610-B	1.5/16-12	7/8-14	1
883FS1612-A	1.1/16-12	--	1

SAE 070123
TIPO A
REQUER FLANGE 841F

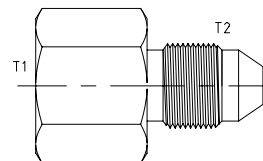

SAE 070105
TIPO B

889F
COTOVELO 45° SWIVEL
SAE 070321

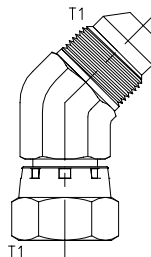

CÓDIGO	T1 UN/UNF	TUBO D.E
889F- -06	9/16-18	3/8
889F- -08	3/4-16	1/2
889F- -12	1.1/16-12	3/4
889F- -16	1.5/16-12	1.1/4
889F- -20	1.5/8-12	1.1/4
889F- -24	17/8-12	1.1/2

Para obter maiores informações sobre nossos produtos , visite o site www.detroit.ind.br
ou envie um e-mail para aplicacao@detroit.ind.br



Detroit Plásticos e Metais Ltda.

Av. Antônio Piranga , 2788 - CEP 09942-000
Diadema – SP – Brasil
Tel. (11) 4360-6700 - Fax. (11) 4075-1717
www.detroit.ind.br - contato@detroit.ind.br